

How to connect to the eduroam Wi-Fi service at another location using Windows 10/11

These instructions will help University of Otago staff and students connect to the eduroam wireless (Wi-Fi) service at participating locations. The default eduroam WLAN settings for your laptop are:

eduroam Wi-Fi Security Configuration	
SSID	eduroam
Security	WPA2-Enterprise (802.1X/EAP)
Authentication Method	PEAP-MSCHAPv2
Encryption Type	AES-CCMP
Login User Account	Staff: username@registry.otago.ac.nz (username format is e.g. doejo91p not first and last name e.g. john.doe) Students: username@student.otago.ac.nz
Validate Server Certificate	AddTrust External CA Root OR AusCERTServerCA.crt

The Trusted Root CA certificate can be downloaded here if required:

<https://www.quovadisglobal.com/download-roots-crl/>

Select: QuoVadis Root CA2
SHA1 - RSA - 4096
Download as DER

QuoVadis Root CA2 SHA1 - RSA - 4096	Valid until: 24/Nov/2031 Serial: 05 09 CRL: http://crl.quovadisglobal.com/qvrca2.crl Download as DER - Download as PEM
---	--

Setting up an eduroam wireless connection at another location using Windows 10/11

This section provides step-by-step instructions to configure your eduroam WLAN settings.

1. Once you are at the eduroam-participating location, click on your **Network Connections** icon (wireless bars) in the system tray, and click on **eduroam** from the available wireless networks, then click **Connect**

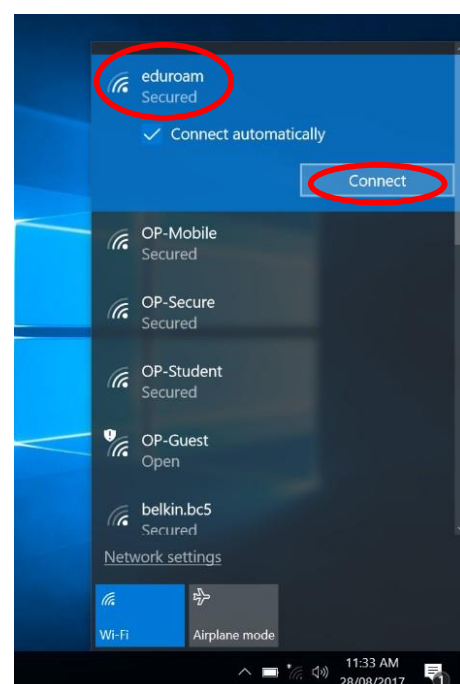

- You will be prompted to enter your University of Otago username
(**Staff:** username@registry.otago.ac.nz
Students: username@student.otago.ac.nz)
and password. Click **OK**.

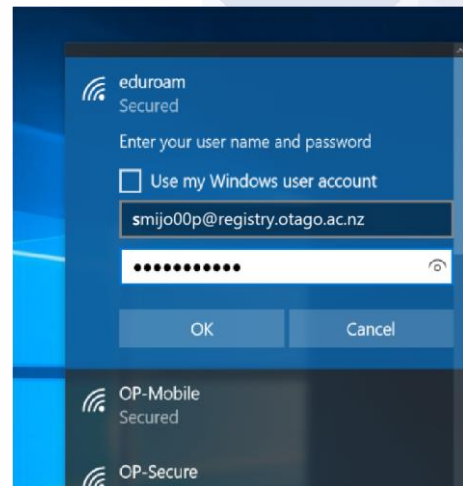

- You will be prompted to accept the credentials (security certificate) from the authentication server. Click on the **Connect** button.

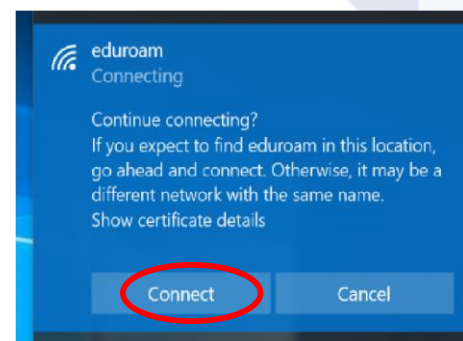

- Open your web browser and go to <https://www.otago.ac.nz> to confirm that you are connected to the eduroam network. If this step fails, please reconnect to the eduroam wireless network by disabling then reenabling your Wi-Fi. You will be asked for your University of Otago login credentials again.

Please contact AskOtago if you need any help with setting up Windows 10/11 for eduroam:

Freephone 0800 80 80 98 (within New Zealand)

Freephone 1800 46 82 46 (within Australia)

Tel +64 3 479 7000

[Enquiry form](#)

[Online chat](#)